

Elm Walk Raynes Park, SW20 9ED

£750,000 Freehold



REQUIRING MODERNISATION THROUGHOUT - This fantastic three double bedroom, semi detached Blay house with garage and substantial rear garden has fantastic scope to extend to the side, loft and rear S.T.P.P to create a larger than average family home. Easy access to Raynes Park, double glazing, off street parking and offered to the market with no onward chain.

Elm Walk, SW20

Approximate Gross Internal Area
Ground Floor = 51.5 sq m / 554 sq ft
First Floor = 51 sq m / 549 sq ft
Garage = 18.5 sq m / 199 sq ft
Total = 121 sq m / 1302 sq ft



First Floor

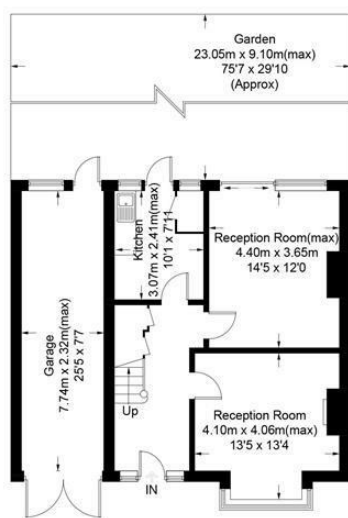

Ground Floor

This floor plan is for representation purposes only and is not drawn to scale. Whilst every attempt has been made to ensure its accuracy measurements are approximate only and should be checked before making any decisions reliant upon them.
Copyright Bespokeplans.co.uk 2016
(ID 302468)

- Chain Free
- Requires Modernisation
- Potential To Extend S.T.P.P
- Semi Detached
- Close to Raynes Park
- EPC Rating D

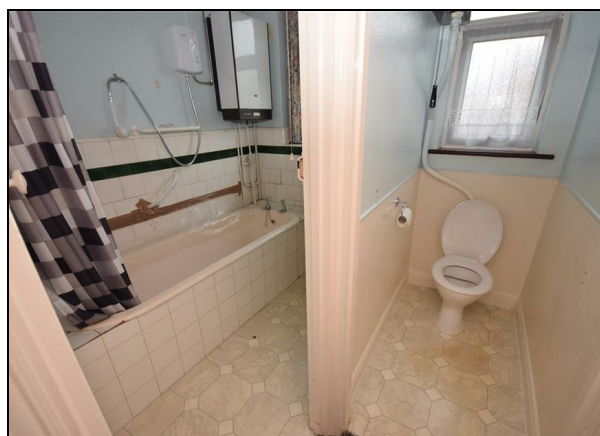

Energy Efficiency Rating		Current	Potential
Very energy efficient - lower running costs			
(92 plus) A			
(81-91) B			
(69-80) C			
(55-68) D		55	
(39-54) E			
(21-38) F			
(1-20) G			
Not energy efficient - higher running costs			
England & Wales		EU Directive 2002/91/EC	

Environmental Impact (CO ₂) Rating		Current	Potential
Very environmentally friendly - lower CO ₂ emissions			
(92 plus) A			
(81-91) B			
(69-80) C			
(55-68) D		46	
(39-54) E			
(21-38) F			
(1-20) G			
Not environmentally friendly - higher CO ₂ emissions			
England & Wales		EU Directive 2002/91/EC	

For Free Mortgage Quote and Best Mortgage Rates, call Ellisons Mortgage Advisor, Darren Marks on 0208 944 9595

Although these particulars are believed to be correct, their accuracy is not guaranteed and they do not form part of any contract.

Ellisons Estate Agents Limited

Registered Office: 4th Floor, Tuition House, St. George's Road, Wimbledon, London SW19 4EU. Registered in England & Wales, company number 7533420